

# Potravinářské armatury



■ Skladový sortiment: jakost 1.4301.

Na objednání dodáváme také v jakosti 1.4404.

Potrubní objímka dvoudílná

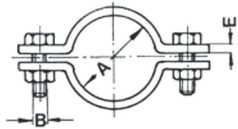

Ø A mm	1.4301	Ø A mm	1.4301
12	■	60,3	■
14	□	70	■
16	□	76,1	■
18	■	85	■
21,3	■	88,9	■
22	■	104	■
25	■	108	■
26,9	■	114,3	■
28	■	129	■
33,7	■	139,7	■
34	■	154	■
40	■	156	■
42,4	■	168,3	■
44,5	■	204	■
48,3	■	219,1	■
52	■	254	■
57	■	306	■

DN	A	B	C	D	E
25	88				52 x 1/6"
32	103				58 x 1/6"
40	113				65 x 1/6"
50	114				78 x 1/6"
65	140				95 x 1/6"
80	159				110 x 1/4"
100	180				130 x 1/4"

Zpětná klapka

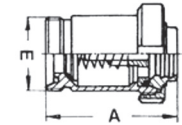

Potrubní třmen dlouhý

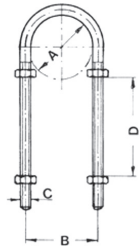

DN	A	B	C	D	E
25	28	36	M 6	30	
32	34	42	M 6	30	
40	40	50	M 8	30	
50	52	62	M 8	30	
65	70	80	M 8	30	
80	85	96	M 10	30	
100	104	119	M 10	30	
125	129	141	M 10	30	
150	154	173	M 12	50	

DN	A	B	C	D	E
25	52	87	89	102	52 x 1/6"
32	53	92	91	102	58 x 1/6"
40	61	97	94	132	65 x 1/6"
50	61	110	100	132	78 x 1/6"
65	63	127	109	132	95 x 1/6"
80	80	142	124	135	110 x 1/4"
100	84	162	135	135	130 x 1/4"
125	112	200	162	216	160 x 1/4"
150	124	230	177	216	190 x 1/4"

Klapka uzavírací - typ GS

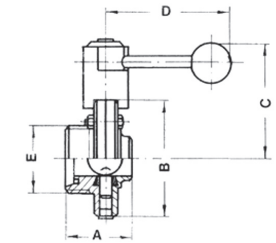

Klapka uzavírací - typ SS

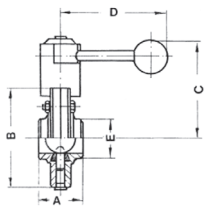

DN	A	B	C	D	E
25	40	87	89	102	31
32	42	92	91	102	38
40	50	97	94	132	44
50	50	110	100	132	56
65	50	127	109	132	73
80	60	142	124	135	88
100	64	162	135	135	112
125	112	200	162	216	137
150	124	230	177	216	163

DN	A	B	C	D	E
25	64	87	89	102	52 x 1/6"
32	64	92	91	102	58 x 1/6"
40	72	97	94	132	65 x 1/6"
50	72	110	100	132	78 x 1/6"
65	78	127	109	132	95 x 1/6"
80	100	142	124	135	110 x 1/4"
100	104	162	135	135	130 x 1/4"
125	112	200	162	216	160 x 1/4"
150	124	230	177	216	190 x 1/4"

Klapka uzavírací - typ GG

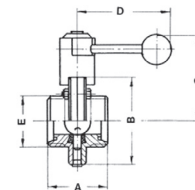

■ skladové rozměry  
□ rozměry na objednávku